

FEATURES

- Requires little installation space on substrates.
- Also compliant to 400V DC.

RATING

Rated voltage and breaking capacity : 380V AC-10kA, 400V DC -10kA(L/R = 2ms)
 Minimum breaking current : 380V AC/400V DC - 8 times the rated amperage
 Maximum arc voltage : 700V

cUL standard approved rating

Same as the standard rating



Specifications

Ta=25°C

Type	Rated Amperage (A)	Fusing I ² t (A ² S)	Shutdown I ² t (A ² S) at AC380V 10kA	Power Loss (W)	Weight (g)
350GHK050UL	50	222	3000	5.1	22.5
350GHK080UL	80	568	6390	10.1	
350GHK100UL	100	888	9150	16.5	

Fusing Characteristics

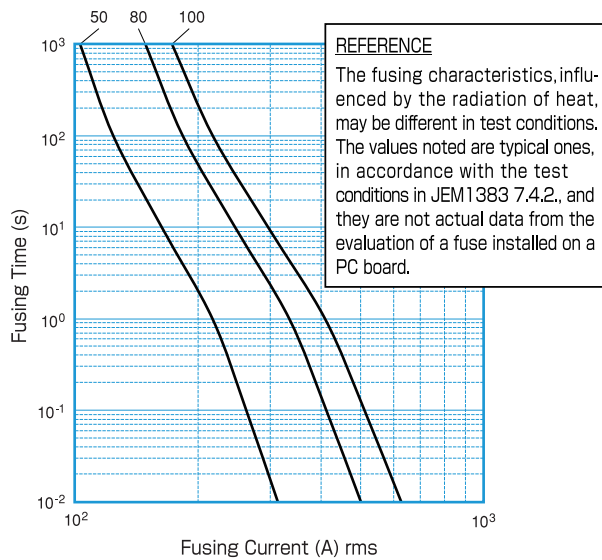

Temperature Rise

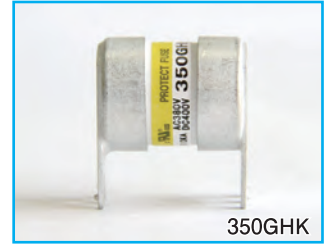
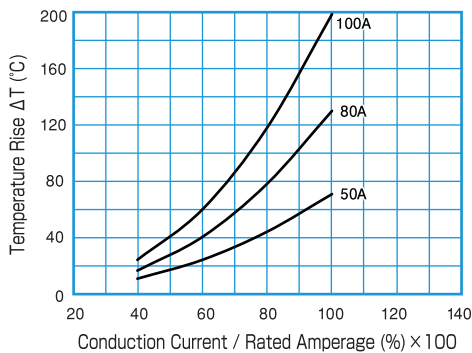

CAUTION!

- Read "FOR SAFE USE" at the back of this catalog before use.
- Fuse should be used less than 50% of their rated current.
- Arc re-ignition may occur if the fusing current is less than 8 times larger than the fuse.
- The power loss and the temperature characteristics are studied using an FR-4 board (one-side board) and a 35-μm-thick copper foil with a copper foil width of 2mm/A depending on the rated amperage (e.g. 50 mm width for a product rated at 100 A).

Dimensions

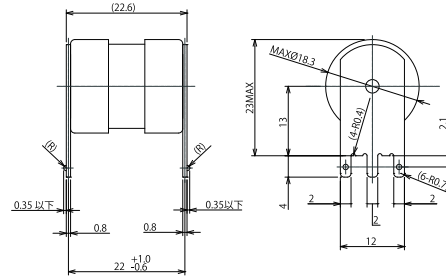

Current-Limiting Characteristics

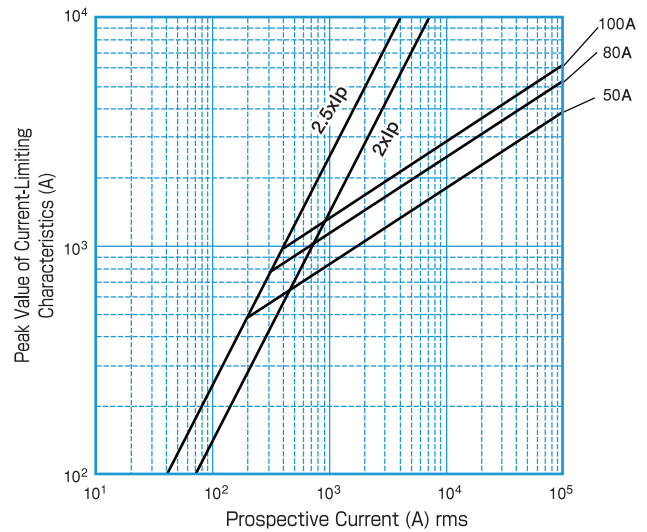

Power Loss

