

660GHK

Fast acting fuse — For protection of semiconductor devices

Features

- ◇ Compliant to AC/DC 660V
- ◇ High breaking capacity (100kA)
- ◇ Board mount type
- ◇ Space-efficient

Specifications

Rated voltage & breaking capacity: AC660V-100kA / DC660V-100kA (L/R10ms)

Minimum breaking current: AC/DC660V (8 times the rated amperage)

Maximum arc voltage: 1400V

Type	Rated Amperage(A)	Fusing I^2t (A^2S)	Shutdown I^2t (A^2S) at AC660V-100kA	Power Loss (W)	Weight (g)
660GHK050	50	167	1600	11.1	34
660GHK080	80	400	3800	21.9	
660GHK100	100	670	7400	31.5	

CAUTION!

- Read "FOR SAFE USE" before use.
- Fuses should be used at less than 50% their rated current.
- Arc re-ignition may occur if the fusing current is less than 8 times larger than the fuse rated current. In this case, the fuse should be used in conjunction with other protectors.
- The power loss and the temperature characteristics are studied using an FR-4 board (one-side board) and a 35μm-thick copper foil with a copper foil width of 0.5 mm/A depending on the rated amperage (e.g., 5 mm width for a product rated at 10 A).

Dimensions (mm)

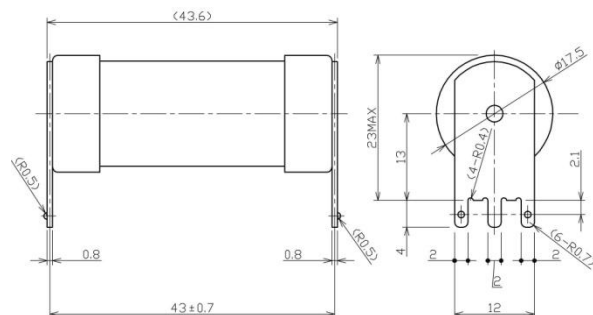

Fusing Characteristics

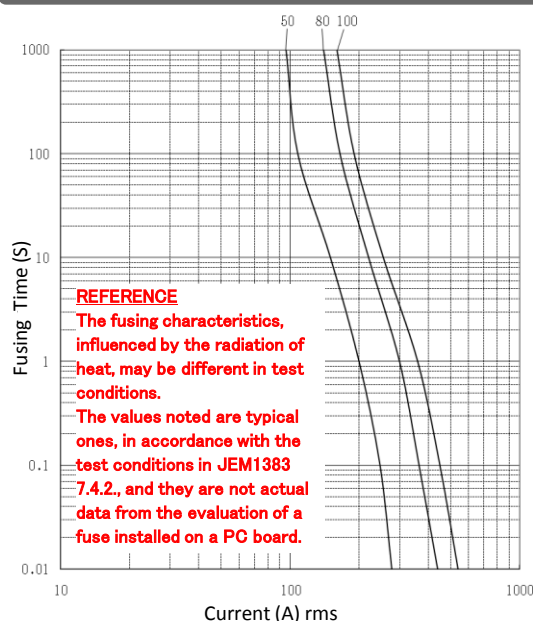

Temperature Rise

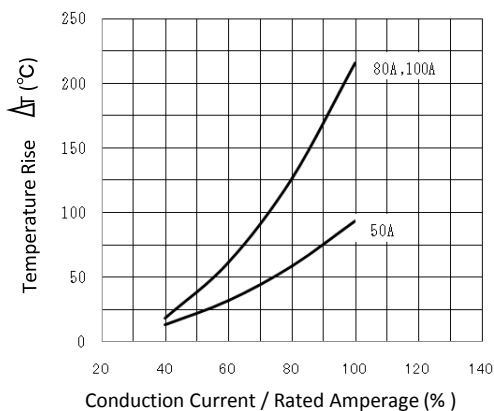

Power Loss

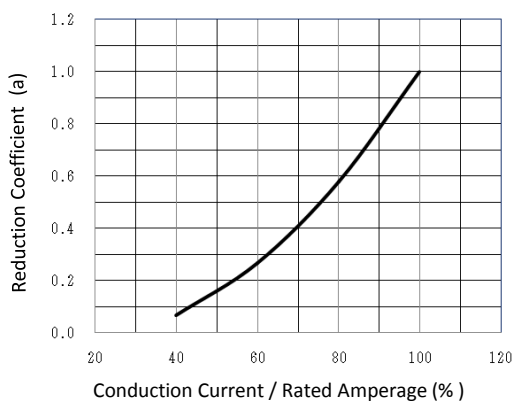

For inquiries, please contact our sales department at;

Tel: 03-3860-8661 Fax: 03-3860-8660 E-mail: uketsuke@hinodedenki.co.jp

All specified data in this leaflet is based on the information at the time of publication, and the products and/or specifications may be subject to change without notice.

We recommend that all our customers check the latest product information on our web site ([http:// www.hinodedenki.co.jp](http://www.hinodedenki.co.jp)) as well as contacting us before placing orders.